

# 产品尺寸:

型号: 02.FGG.0T.002.CA52ZN

定位销 芯数 线夹

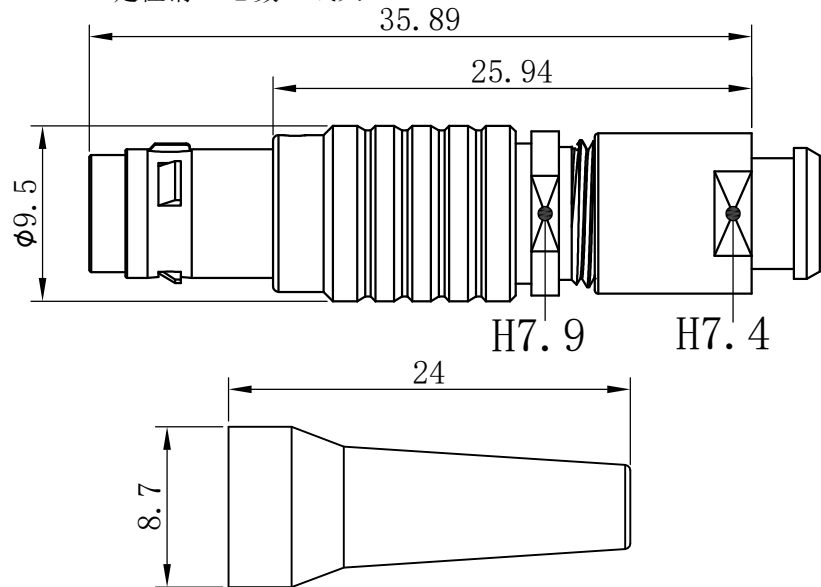

型号: 02.FHG.0T.002.CA52ZN

定位销 芯数 线夹 35.3

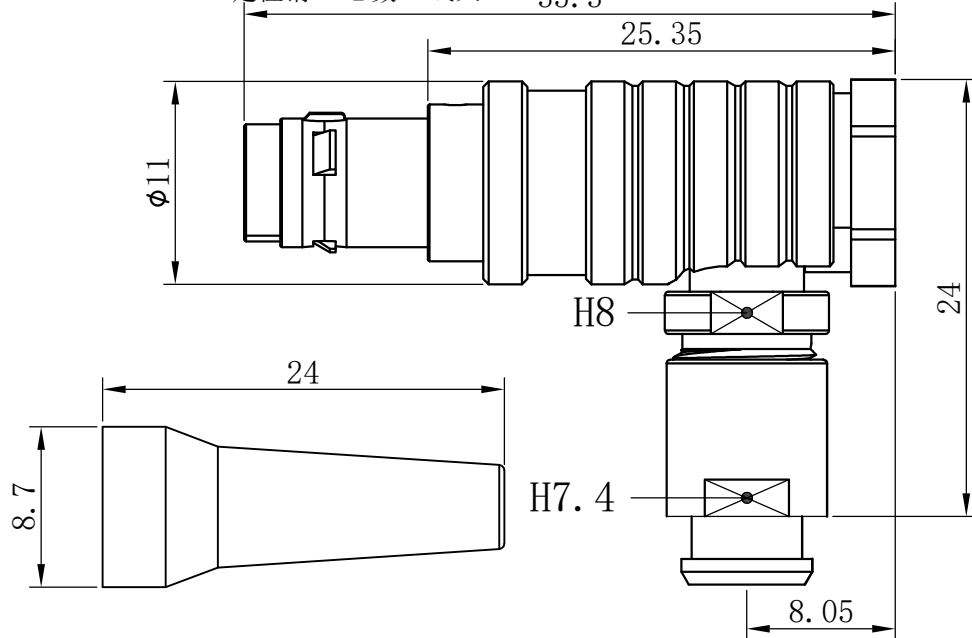

# 焊接端视图:

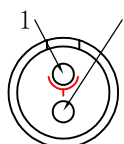

公针芯焊接端  
焊接排序图

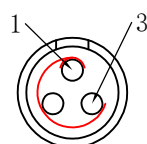

公针芯焊接端  
焊接排序图

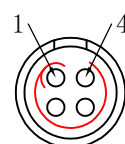

公针芯焊接端  
焊接排序图

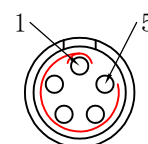

公针芯焊接端  
焊接排序图

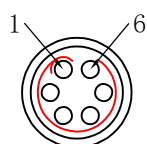

公针芯焊接端  
焊接排序图

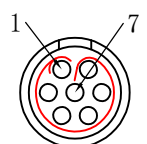

公针芯焊接端  
焊接排序图

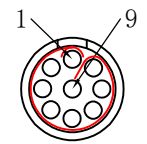

公针芯焊接端  
焊接排序图

# 附表:

芯数	002	003	004	005	006	007	009
接触电阻	6mΩ	6mΩ	8mΩ	8mΩ	10mΩ	10mΩ	10mΩ
额定电流	9.0A	7.0A	6.0A	5.5A	2.0A	2.0A	1.5A
针芯规格	φ0.9	φ0.9	φ0.7	φ0.7	φ0.5	φ0.5	φ0.5

产品尺寸:

型号: EGG. 0T. 002. CL

定位键 芯数

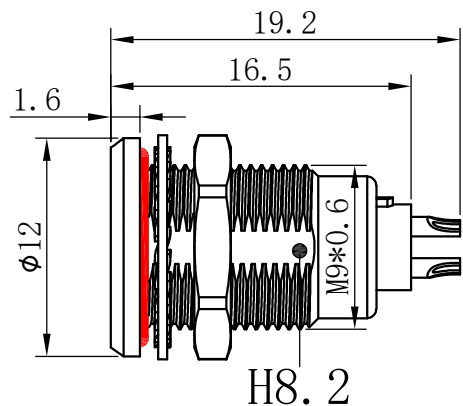

型号: EEG. 0T. 002. CL

定位键 芯数

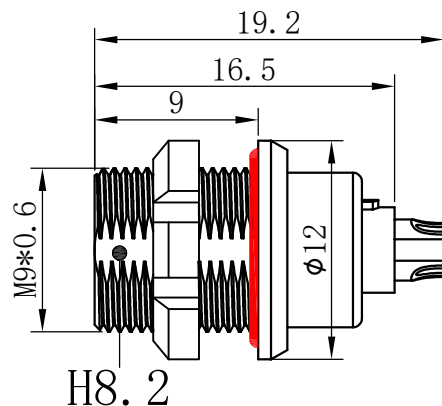

型号: HGG. 0T. 002. CL (密封型)

定位键 芯数

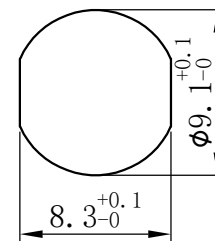
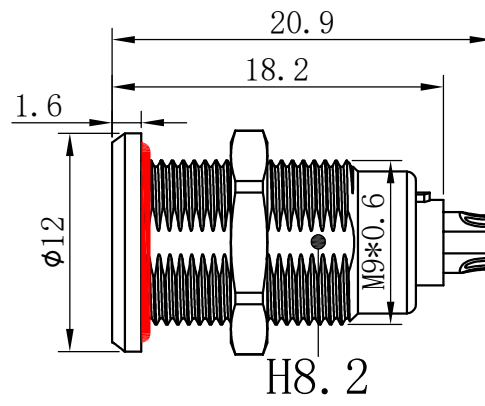

面板开口尺寸

焊接端视图:

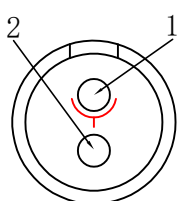

母针芯焊接端  
焊接排序图

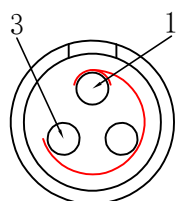

母针芯焊接端  
焊接排序图

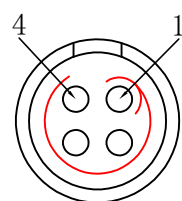

母针芯焊接端  
焊接排序图

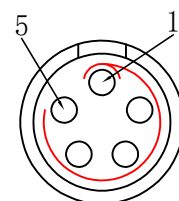

母针芯焊接端  
焊接排序图

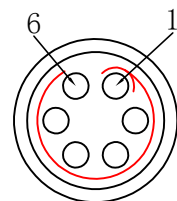

母针芯焊接端  
焊接排序图

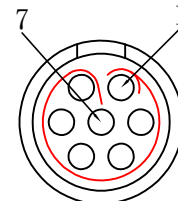

母针芯焊接端  
焊接排序图

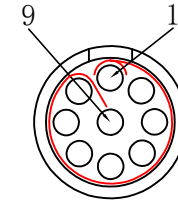

母针芯焊接端  
焊接排序图

附表:

芯数	002	003	004	005	006	007	009
接触电阻	6m Ω	6m Ω	8m Ω	8m Ω	10m Ω	10m Ω	10m Ω
额定电流	9.0A	7.0A	6.0A	5.5A	2.0A	2.0A	1.5A
针芯规格	φ0.9	φ0.9	φ0.7	φ0.7	φ0.5	φ0.5	φ0.5